

# 821 15 Z1 IN



DX  
SX



**FOR YOUR SAFETY WARNING**

**kg ?**

[www.camar.it/warning](http://www.camar.it/warning)

<b>3D</b> 	<b>12 mm</b> 	<b>18 mm</b> 	<b>3 mm</b> 	<b>4</b> 
	<b>Fe</b>	<b>ZAMAK</b>	 <a href="http://www.camar.it">www.camar.it</a>	

50	1800	100
----	------	-----

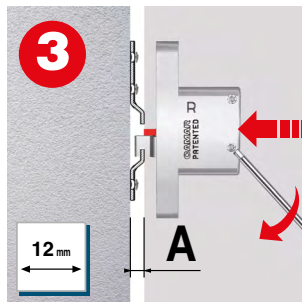
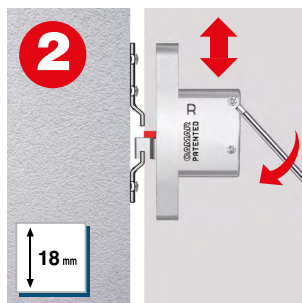

**A = 9-12 mm**

**A = 0-9 mm**

**3D** After assembly, verify that the anti-drop system has been activated.

**3D** Verificare dopo il montaggio l'avvenuta attivazione del sistema antisgancio.

**1** **306**  
40-43

**9** **810 15 □ 06 08** 652

**9** **895 AS Z1 12 94** 688

**9** **4** **809**  
638-641