

816 AS Z1 50

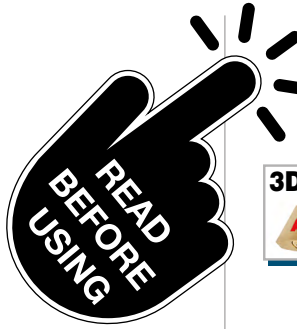

DX
SX



FOR YOUR SAFETY WARNING

kg ?

www.camar.it/warning

3D 10 mm 12 mm Fe

100 3000 800

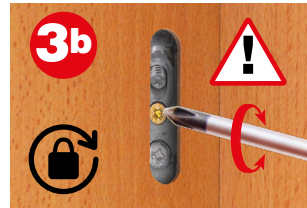
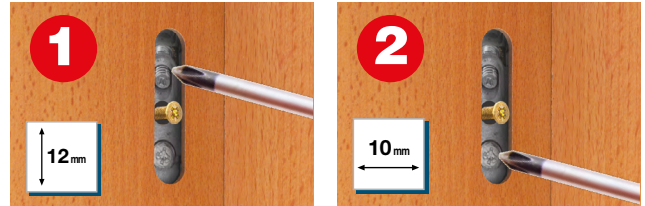

Screw the golden bolt in to its limit point.
 Avvitare fino a fine corsa.



After assembly, verify that the anti-drop system has been activated.
 Verificare dopo il montaggio l'avvenuta attivazione del sistema antigancio.

BRACKET **PLATE**
BP
14,5mm

877 A5 PZ 00 60 679
877 A5 Z1 679
877 Z1 680

BRACKET **PLATE**
BP
14,5-24,5mm

877 A5 Z1 DP 60 677

MIN. 3

810 B2 45 12 643

MIN. 5

810 P0 45 12 644